

Course Scheduling Workflows

EAB: Student Enablement Application

Current Term, Add/Drop Courses

EAB: Student Enablement Application

EAB: Student Enablement - Wireframe - Add/Drop Courses from mobile

Timeline - Add/drop period start

Timeline - Add/drop period last day

Current course list

Course Details

Success / swap



Error Cases:
No other sections available

Use Cases:

Drop Course From Current Term Schedule

As a student, I want to drop a course from my schedule that I no longer need/want to take for the semester. Student can determine if the drop was successful and is provided with user-friendly message if the transaction fails for any reason

Use Cases:

Add Course to Current Term Schedule

< story coming >

EAB: Student Enablement - Wireframe - Add/Drop Courses from mobile (con't)

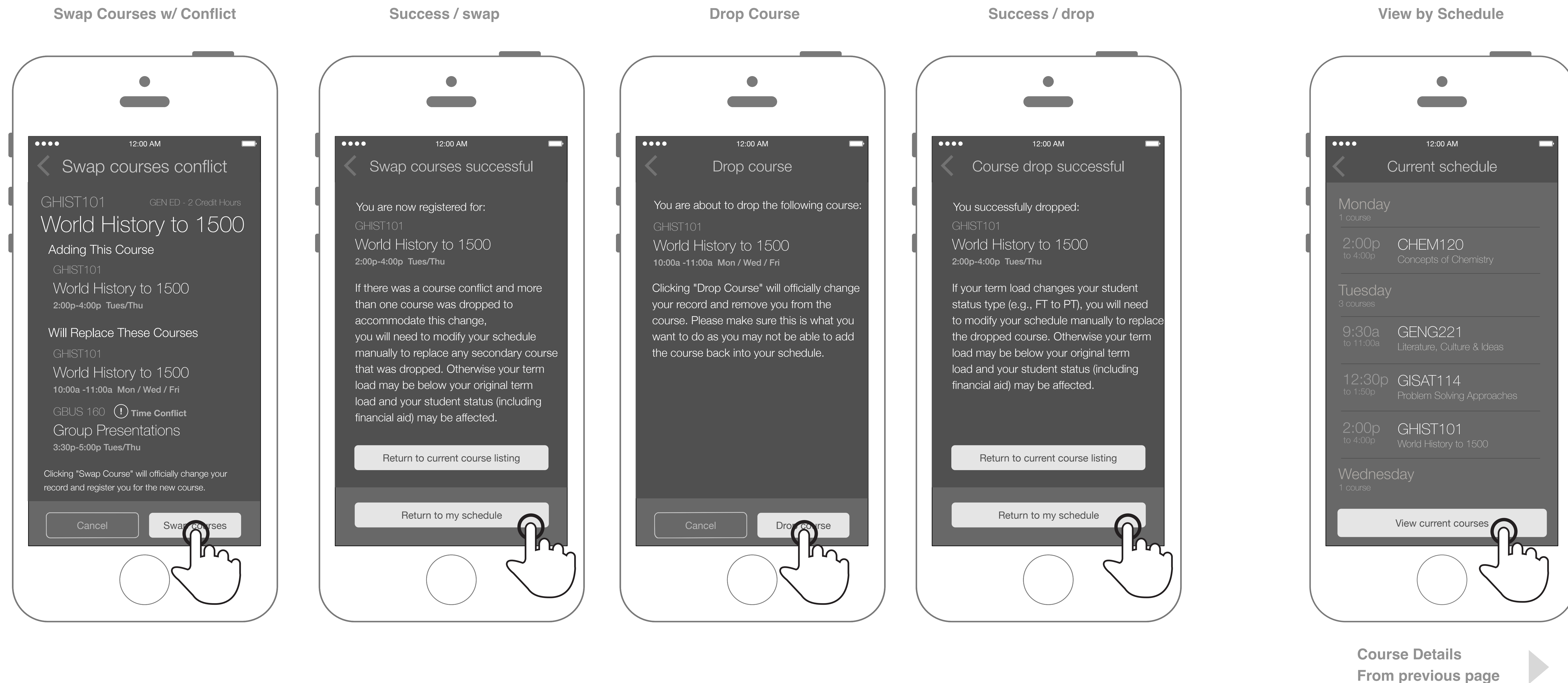

Use Cases:

Drop Course From Current Term Schedule

As a student, I want to drop a course from my schedule that I no longer need/want to take for the semester. Student can determine if the drop was successful and is provided with user-friendly message if the transaction fails for any reason

Use Cases:

Add Course to Current Term Schedule

< story coming >

Course Exploration / Pre-Reg

EAB: Student Enablement Application

EAB: Student Enablement - Wireframe - Courses - Recommendation / Select Courses of Interest View (Without dates)

Timeline - Browse catalog

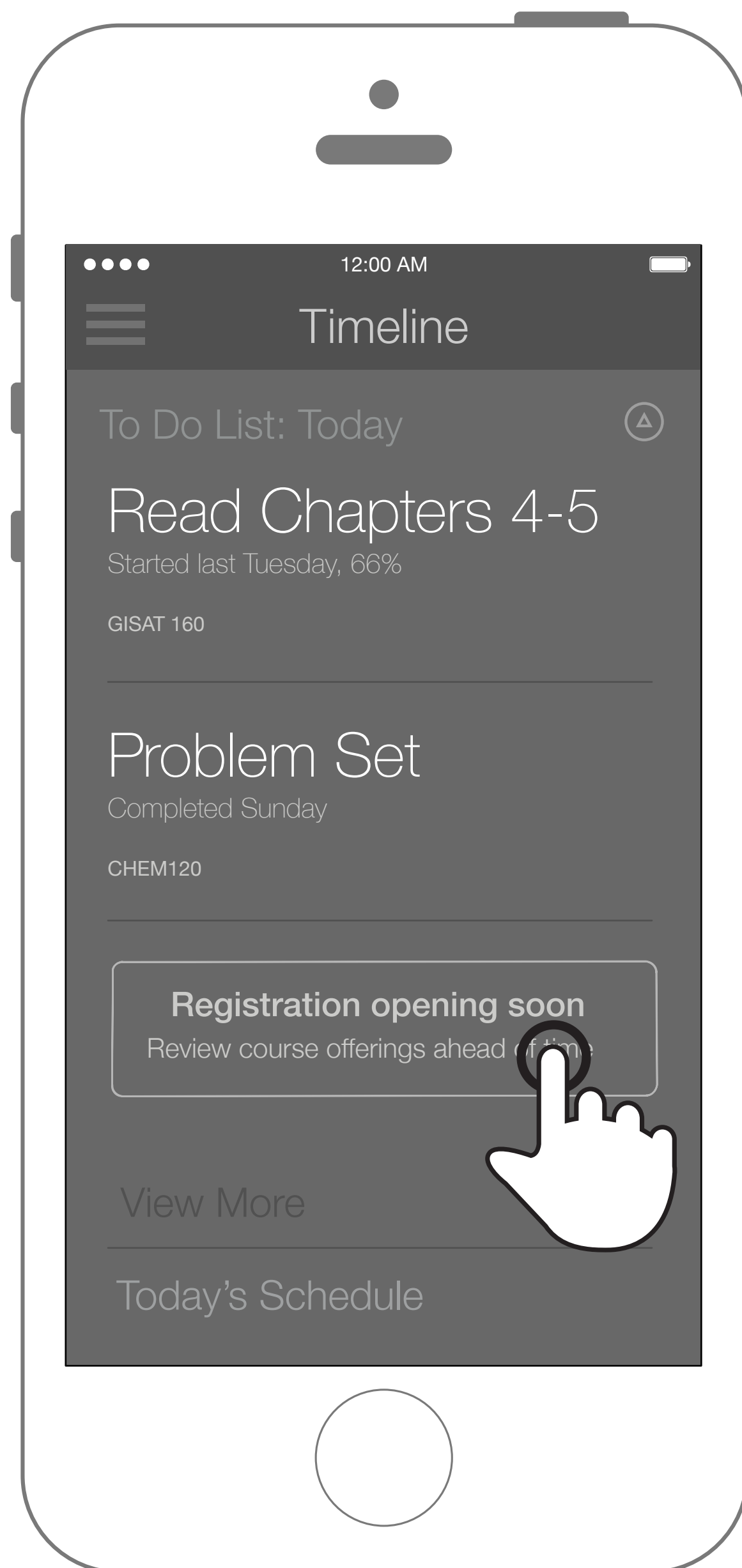

Course picker w/o dates

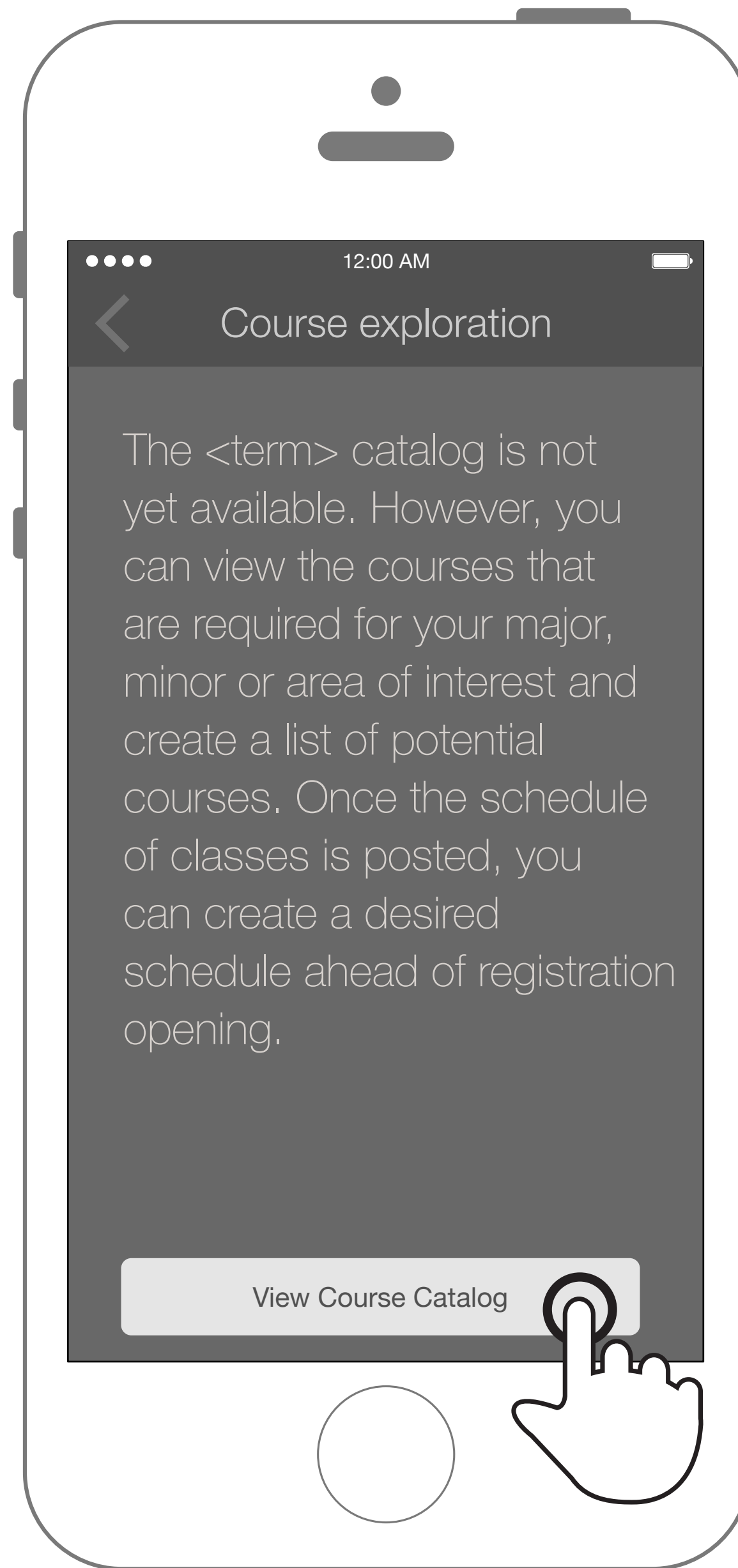

Enter into Major
Matcher/Degree Reqs.
< TBD >

My saved course listing

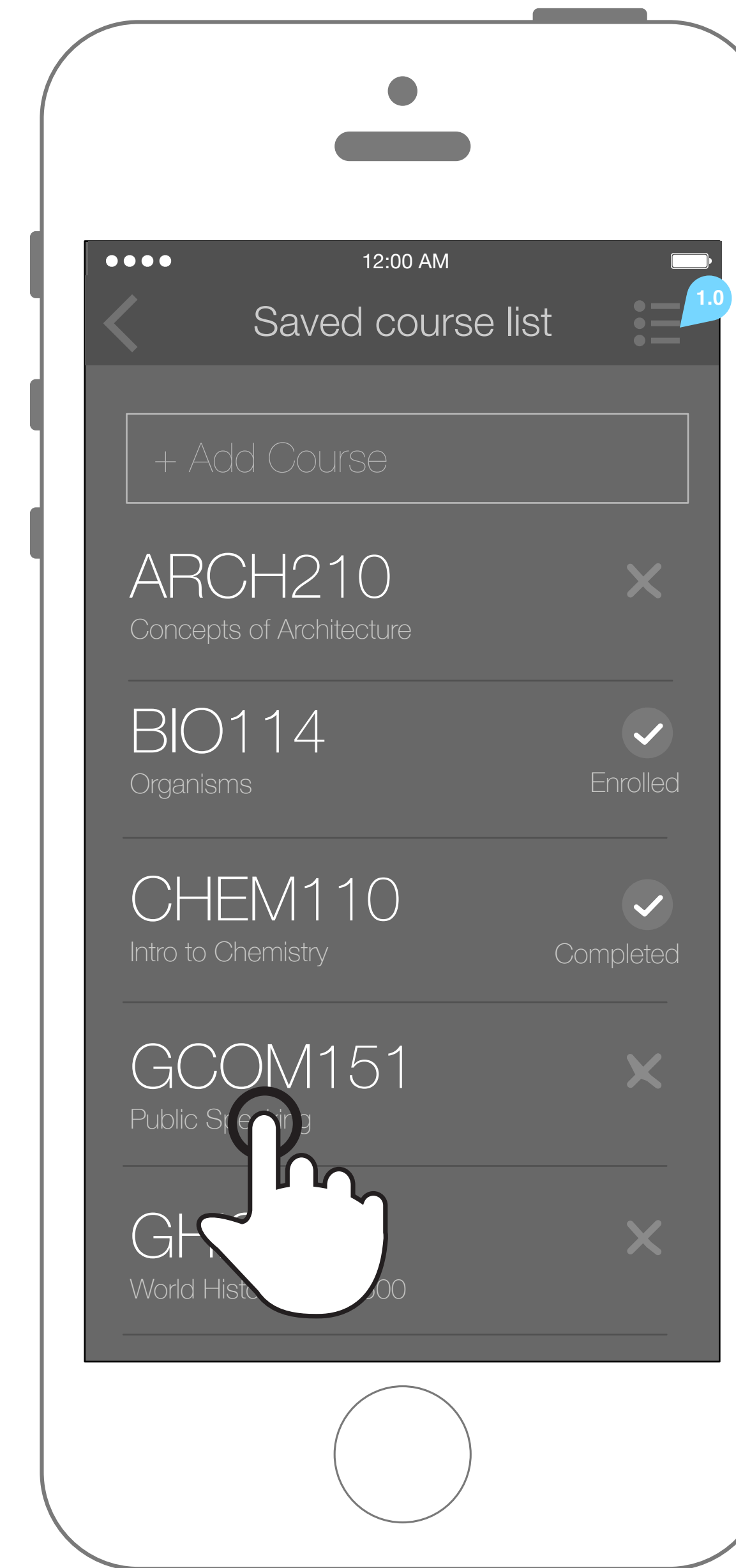

Includes completed,
Includes enrolled,
Sorted by Alpha

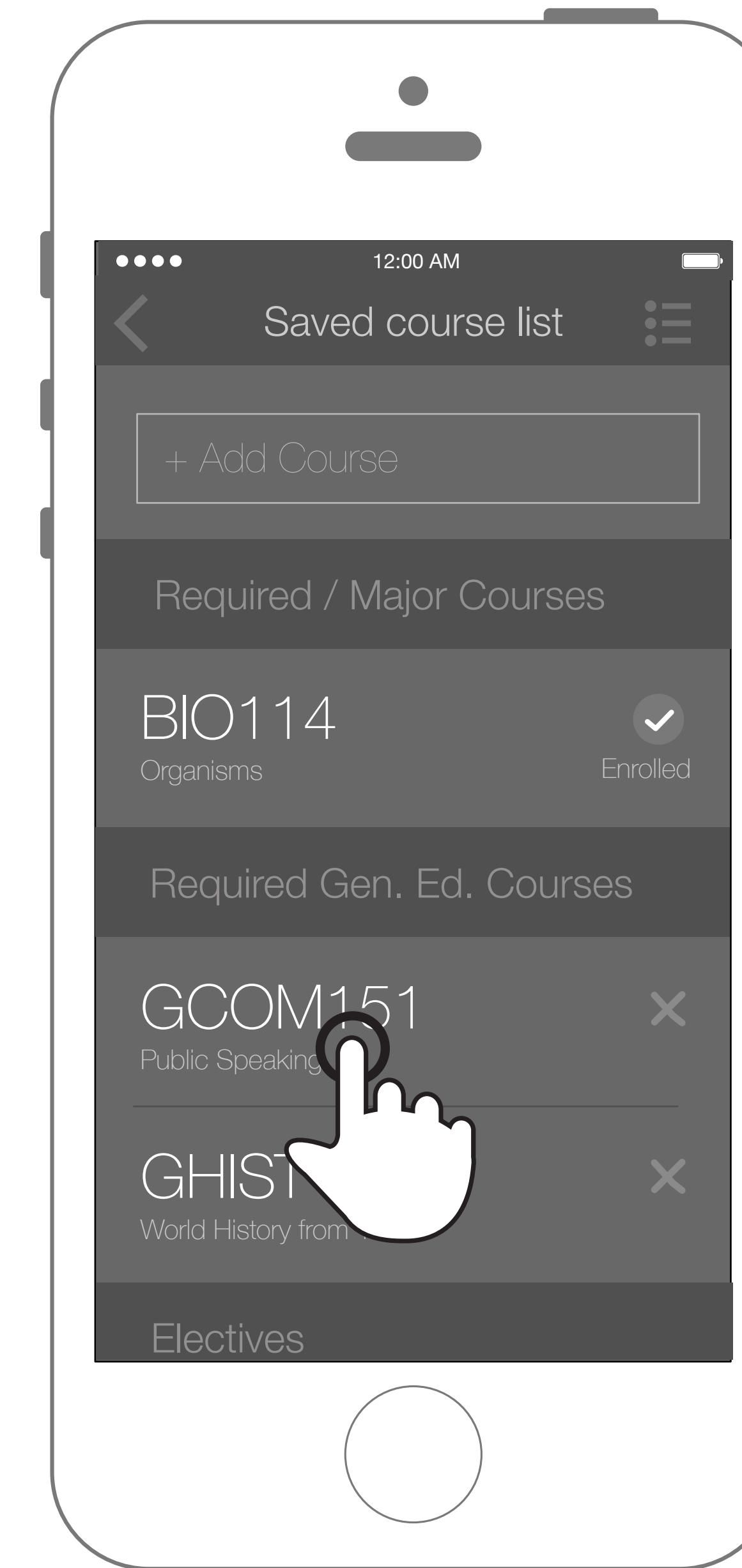

Include type,
Includes enrolled,
Sorted by Type

Course detail, w/o times

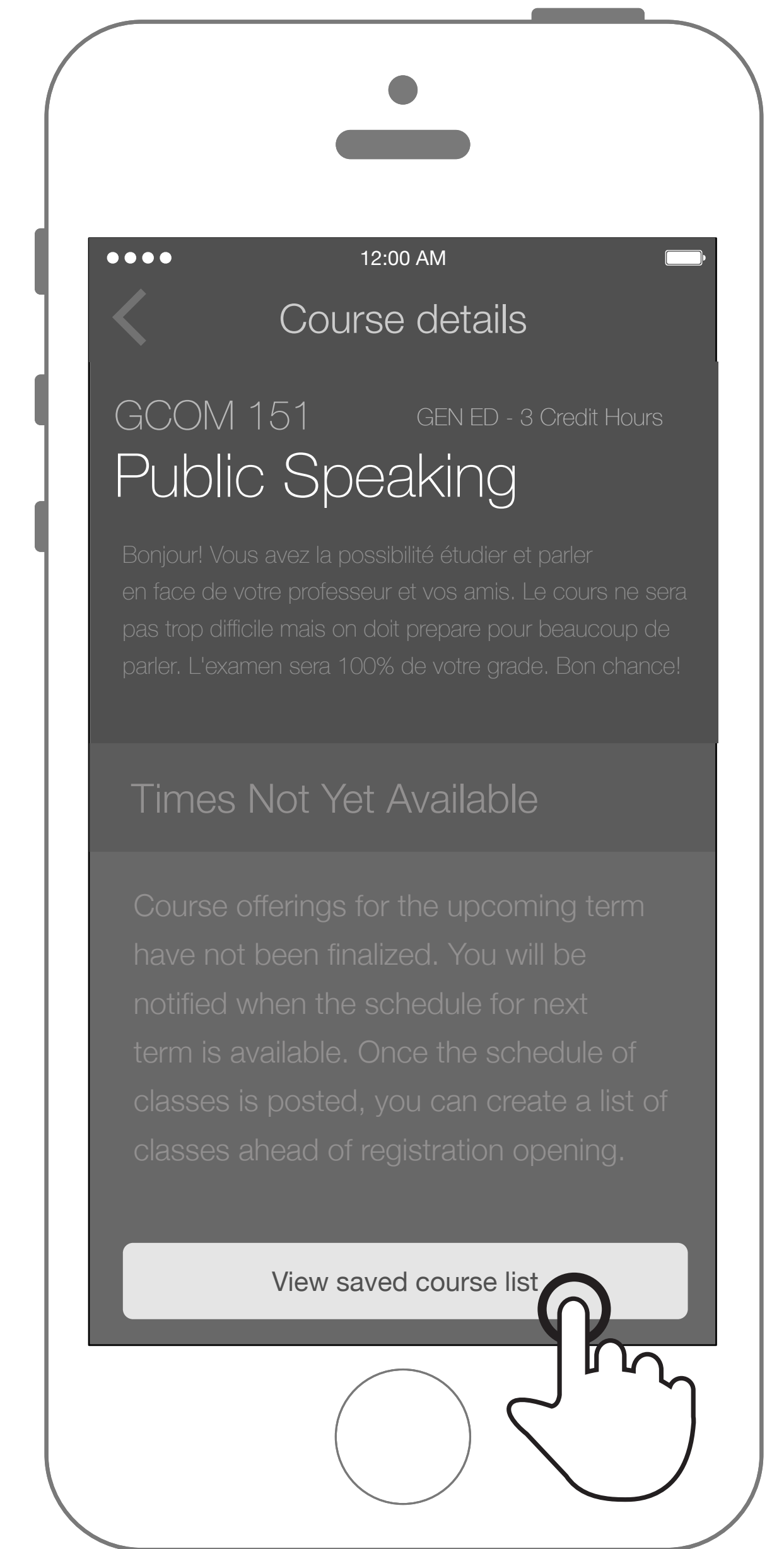

1.0 Mode menu options

Menu items include:

- Include status of completed
- Include status of enrolled
- Include type (Gen Ed, Major)

Sort by Alpha

Sort by Type

Sort by Status

Course Exploration / Registration

EAB: Student Enablement Application

EAB: Student Enablement - Wireframe - Register Courses - Recommendation / Schedule View (With dates)

Course picker w/ dates for student who's not made a list

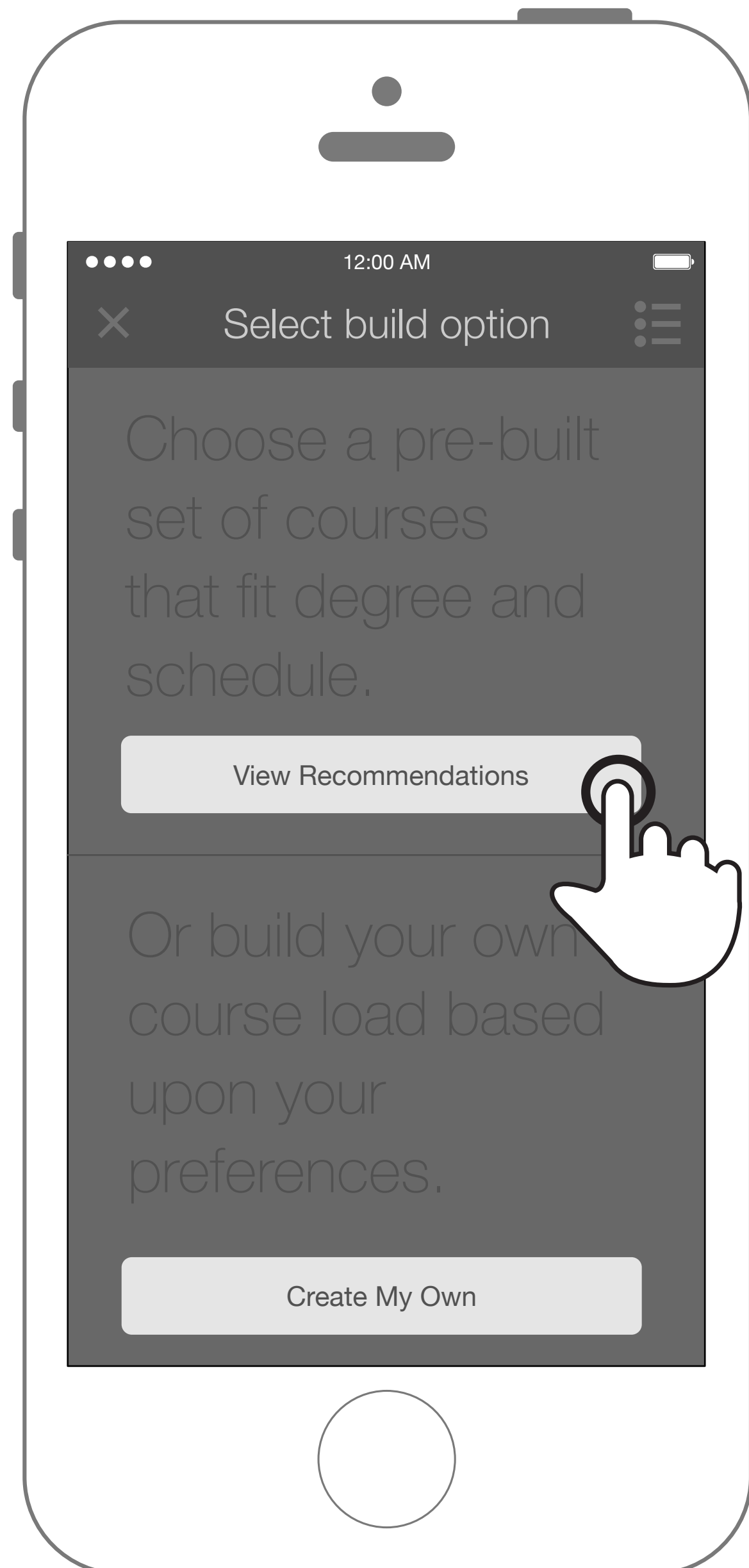

Spinner w/ Feedback

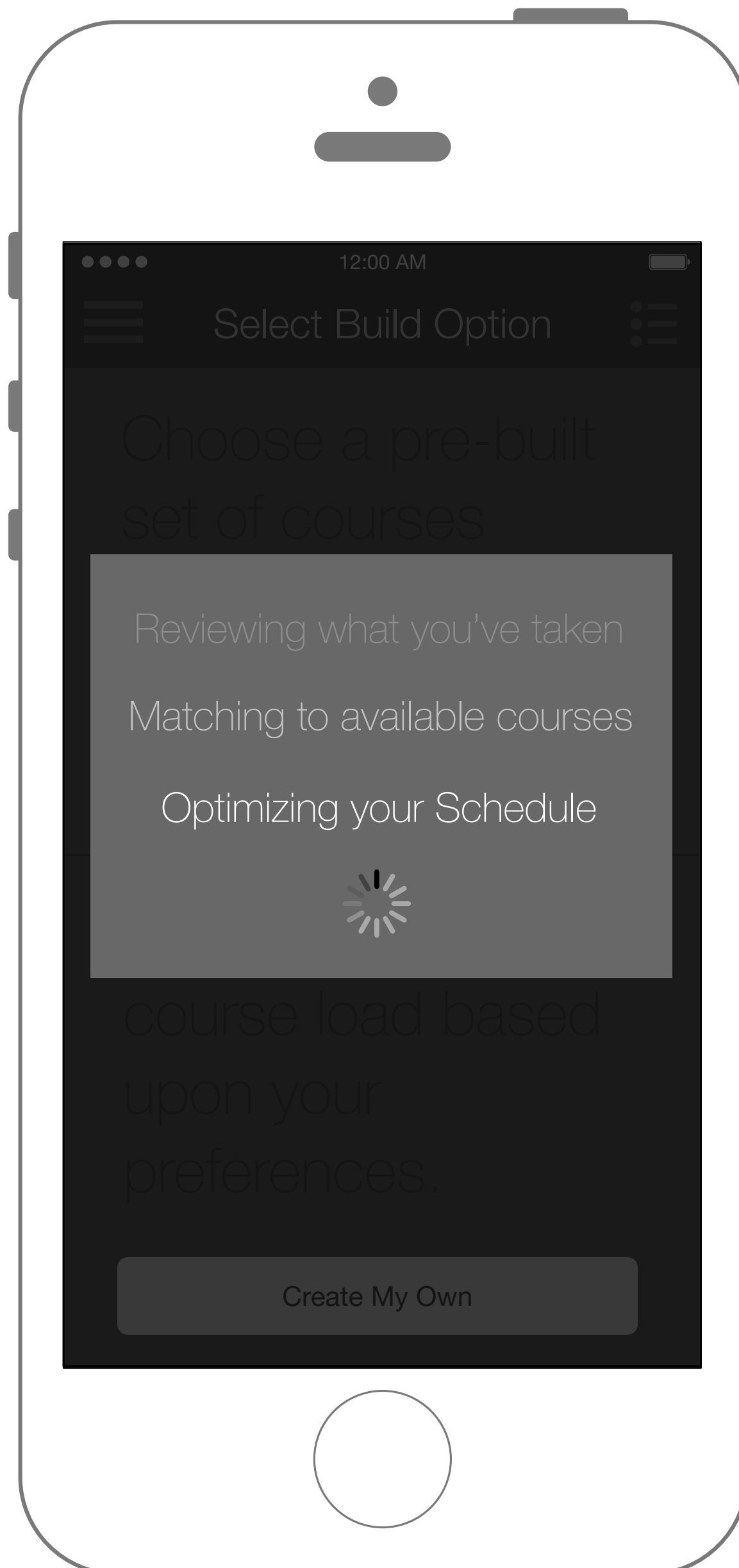

Schedule View

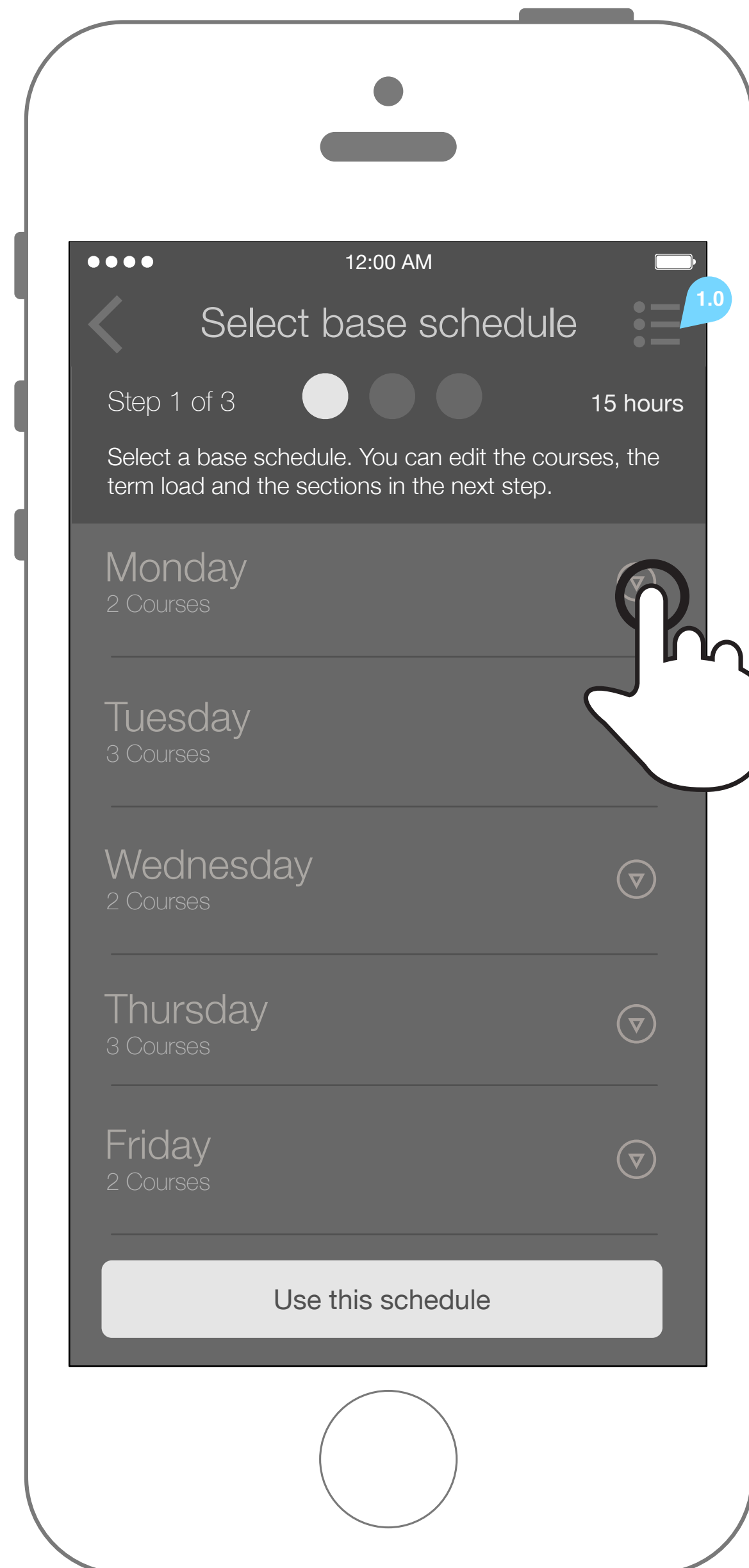

View as schedule

Expand Day / Details

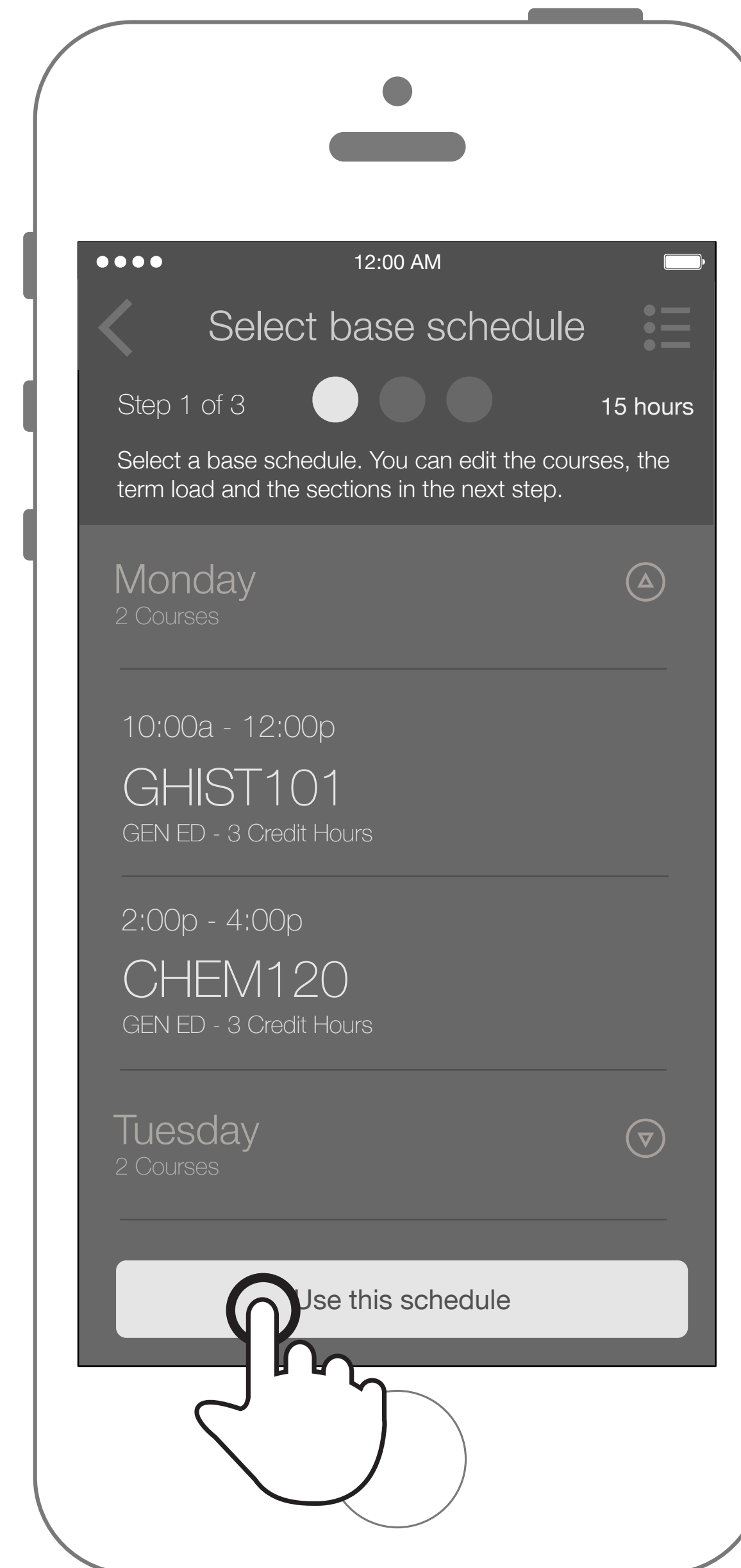

View as schedule, Scheduled time only

Edit Mode

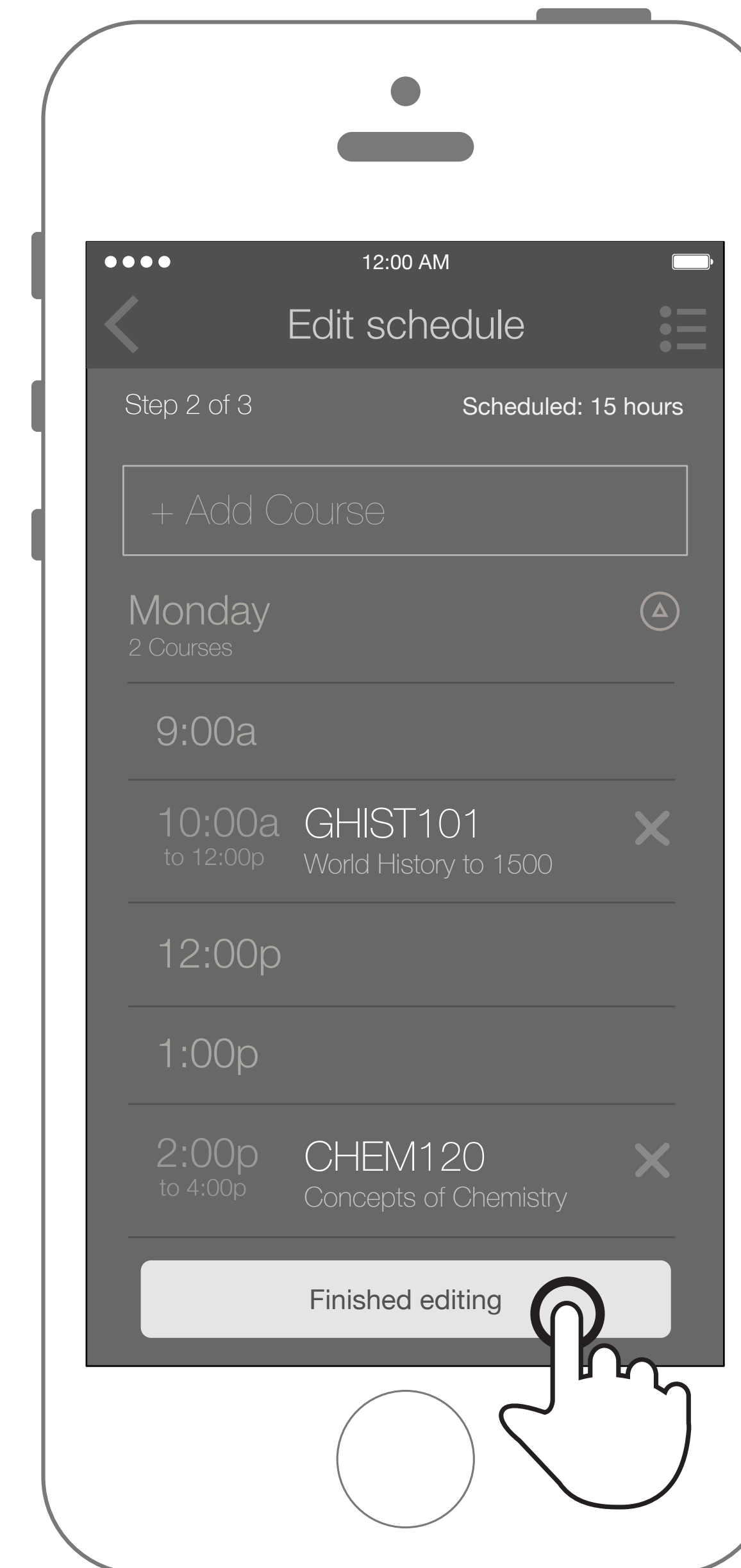

View as schedule, include free time

Finalize

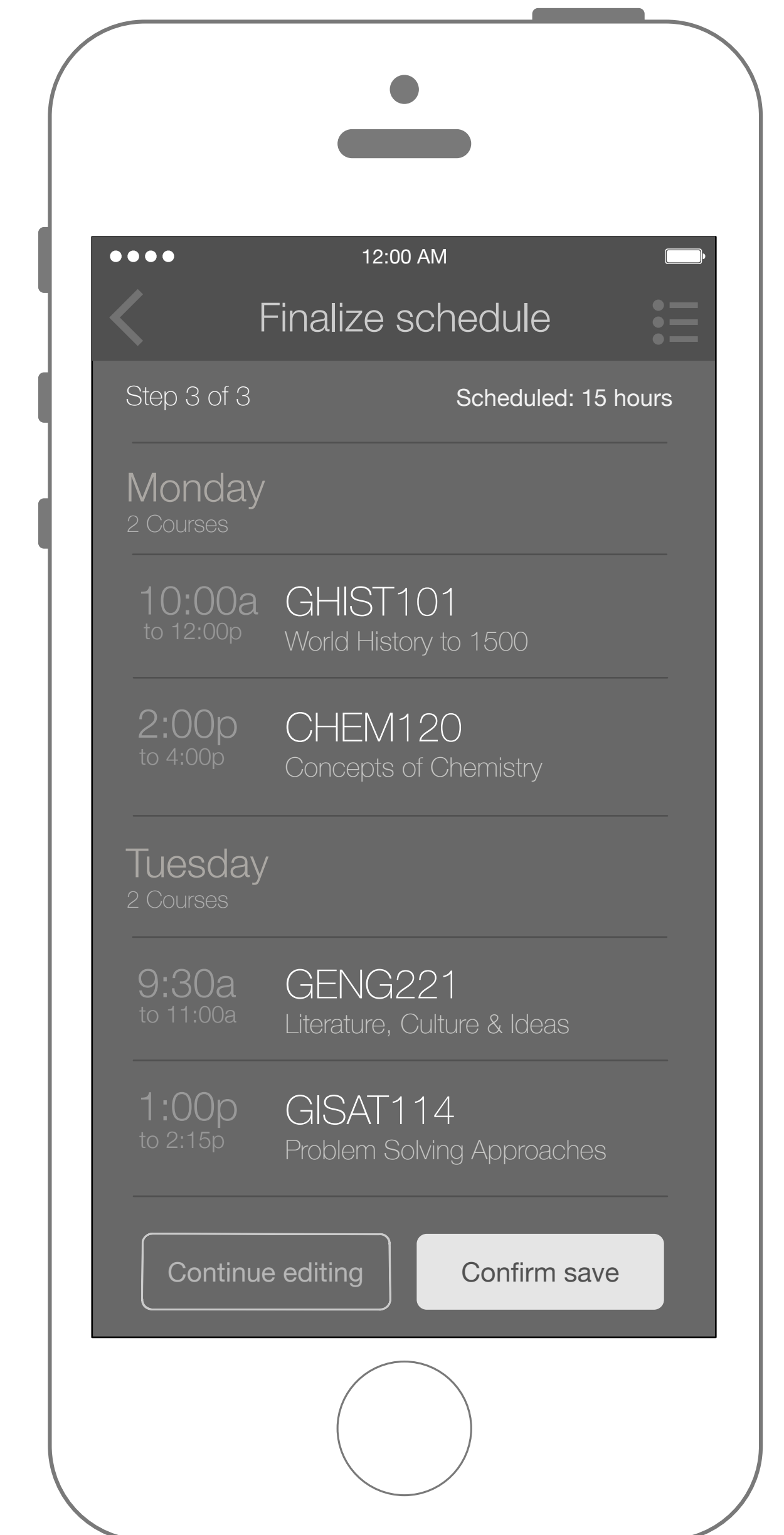

View as schedule, Scheduled time only

Use Cases:

Draft Course Schedule

As a student I want/need to Prepare my schedule before first day of registration because I don't want to have to figure it out "on the clock"; I want to share my schedule with friends, advisor, family; I want to have a couple of options in case I don't get into some of the courses I want; I want to ease my anxiety/be in control

1.0 Mode menu options

Menu items include:

- View as course list
- View as schedule
 - Include free time
 - View scheduled time only

EAB: Student Enablement - Wireframe - Register Courses - Recommendation / Schedule View (With dates)

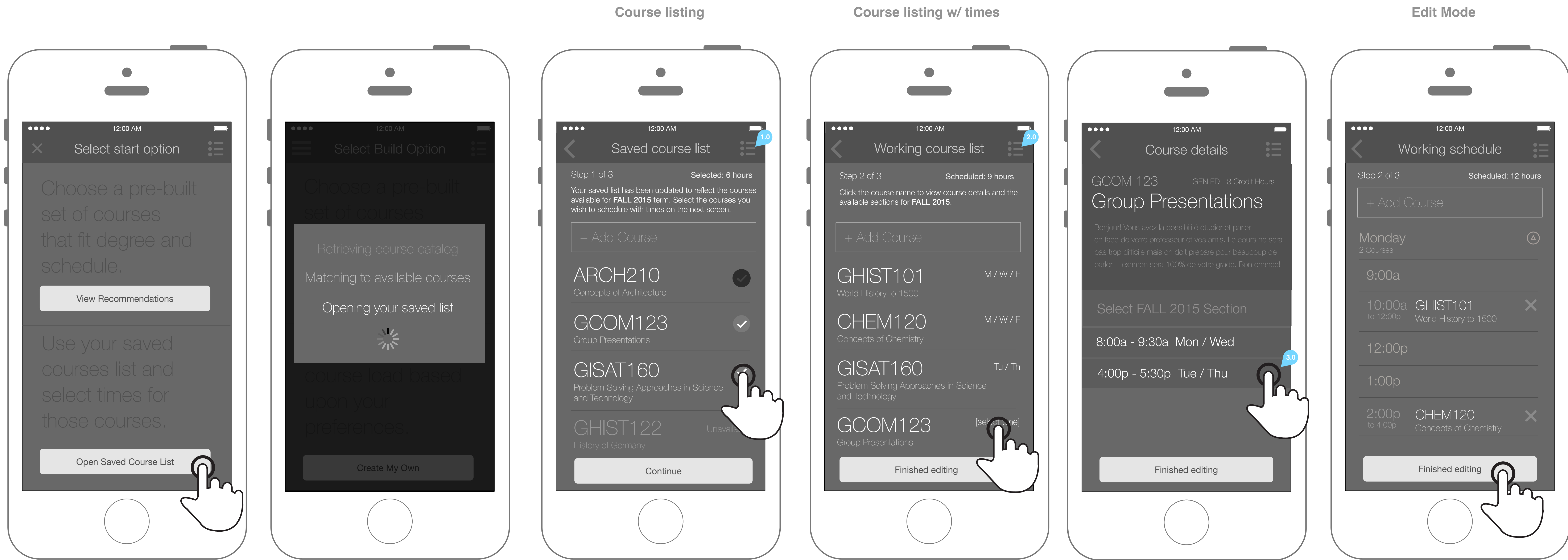

Include unavailable
Sort by Alpha

1.0 Mode menu options
Menu items include:

- Include unavailable
- Include type (Gen Ed, Major)

Sort by Alpha
Sort by Type

2.0 Mode menu options
Menu items include:

- View as working course list
- View as working schedule
 - Include free time
 - View scheduled time only

3.0 Return to previous mode
If user was in course list or schedule mode, that same mode will be the action with the updated info inside that mode.

EAB: Student Enablement - Wireframe - Register Courses - Recommendation / Schedule View (With dates)

Finalize



Register OK

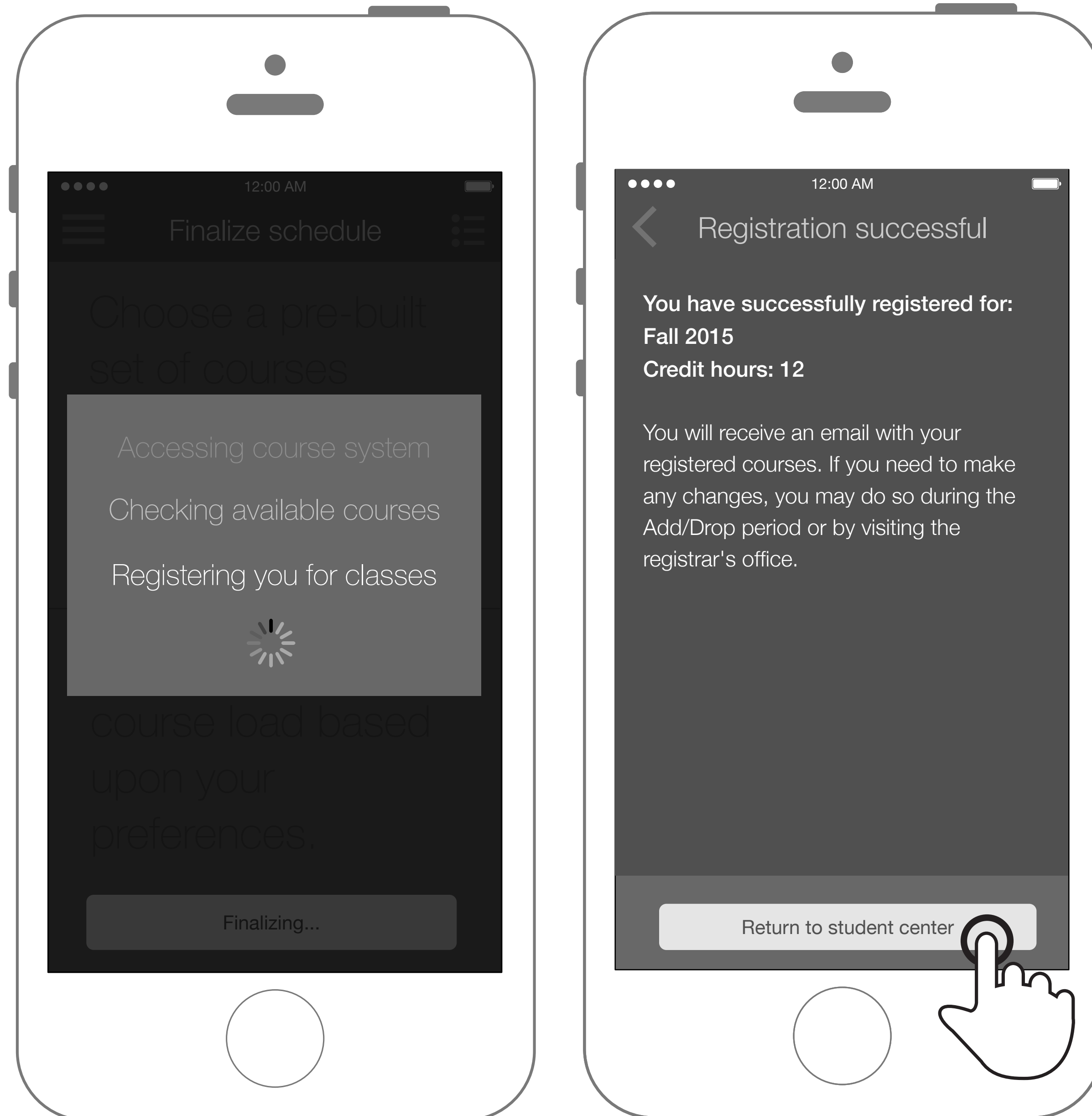

Error Cases:
Registration error, hold
Partial registration

EAB: Student Enablement - Wireframe - Register Courses - Error States

No other sections available

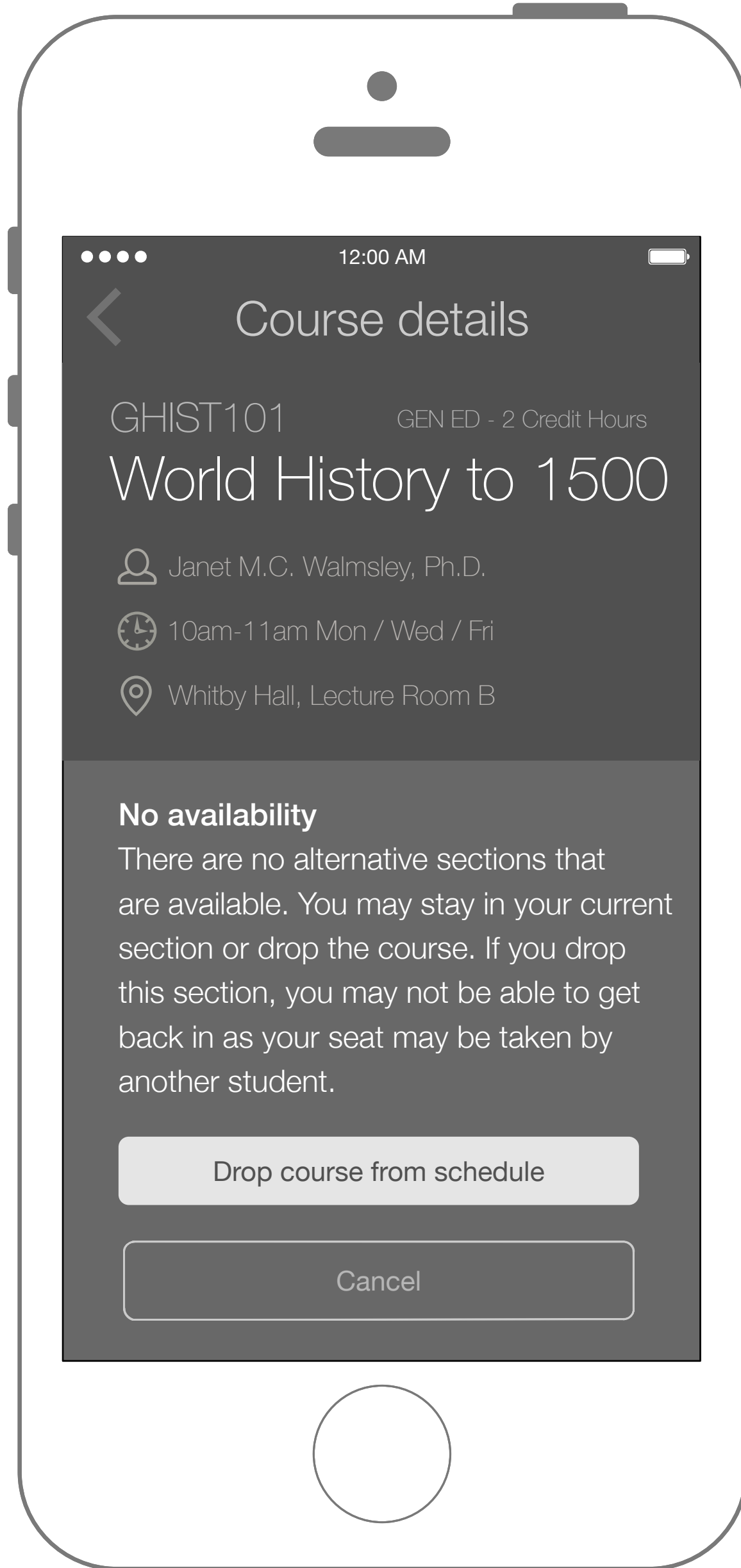

Registration error, hold

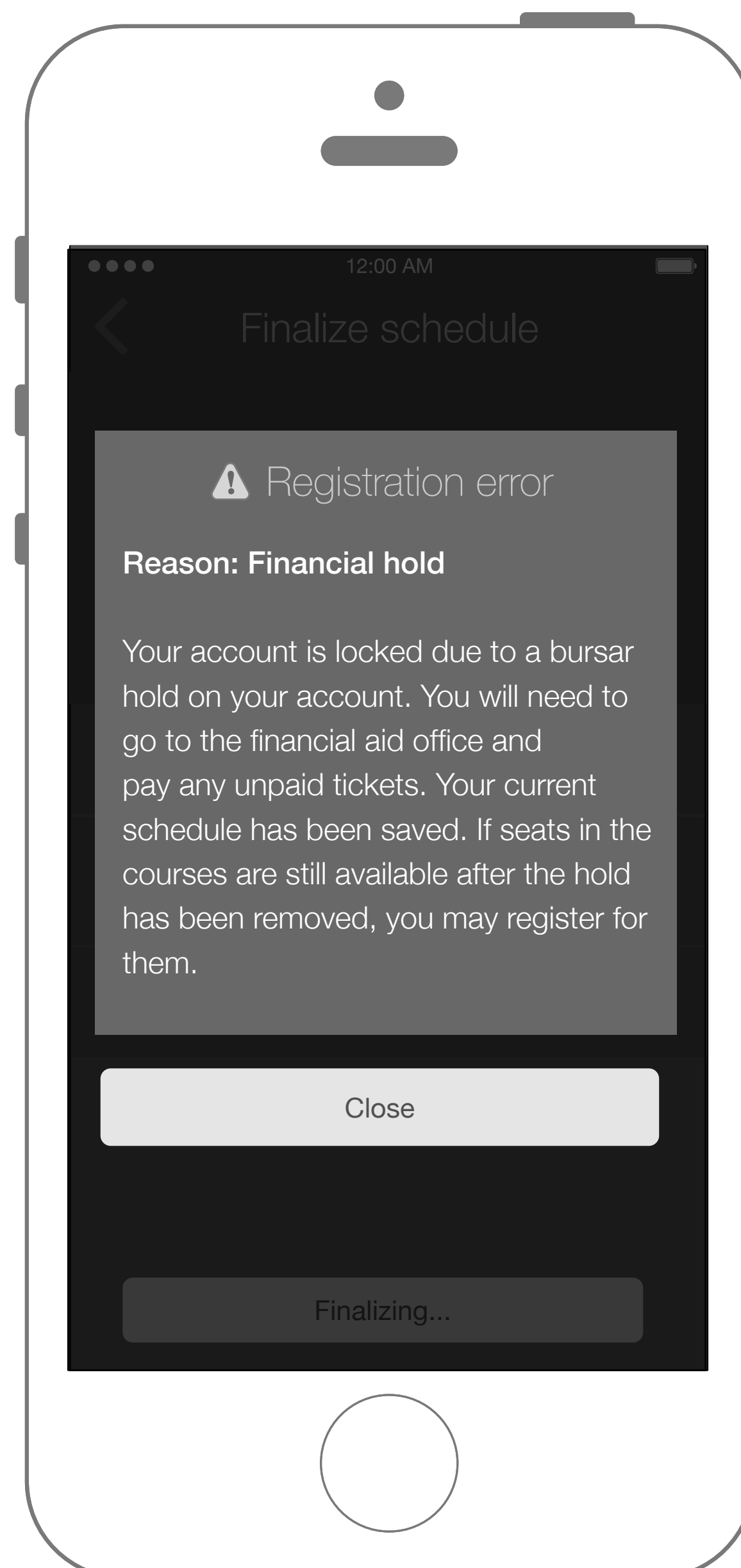

Partial registration

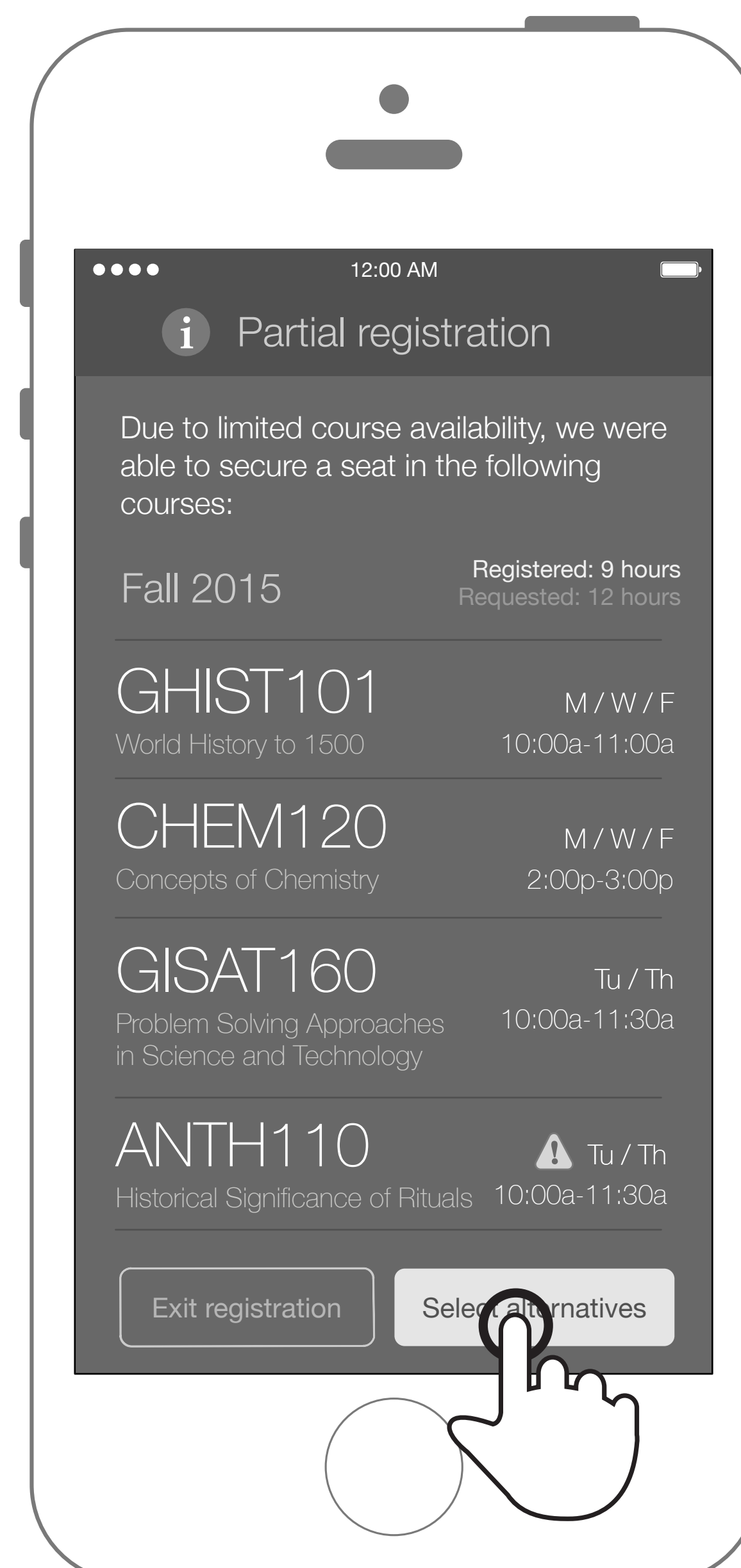

Return to course scheduling.
< TBD >

